



# Joinery by Bears.



## KEY FEATURES:

- Natural Walnut Finish
- Wall-Hung Features
- Soft Closure Mechanism
- Sleek Handleless Design
- Removable Storage Organizer
- Silica-Free Stone Top

## The Ashton Vanity



01. Above-Mount Basin



02. Feature Handle



03. The Natural Walnut Finish

Each piece features a beautiful, unique grain. Feel the natural beauty of the walnut.

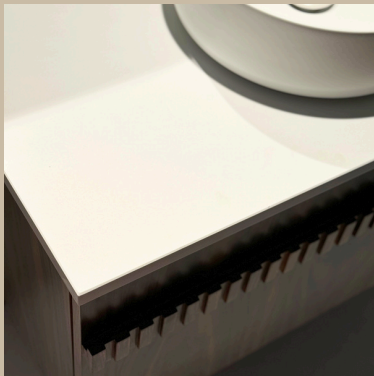

04. Clean and Minimalistic



05. Drawer Organizers  
Includes organized drawer compartments, providing ample storage for all your bathroom essentials. The well-thought-out design ensures that everything has its place, keeping your space neat and tidy.



05. Modern Minimalist Design



# Joinery by Bears.

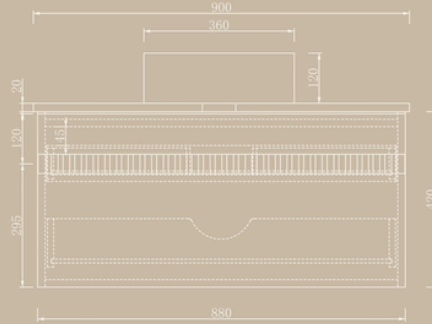
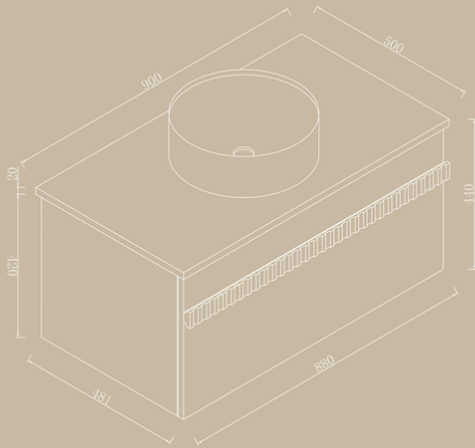

### CABINET COLOUR:

+ Exterior



+ Interior



### BASIN:

+ White ceramic top mount

+ Allow 32 or 40mm waste

(Sell separately)

### HANDLE:

+ Solid walnut wood

## The Ashton Vanity 900

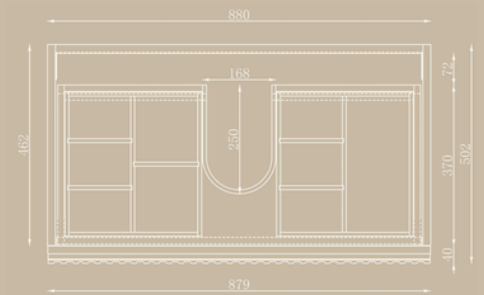
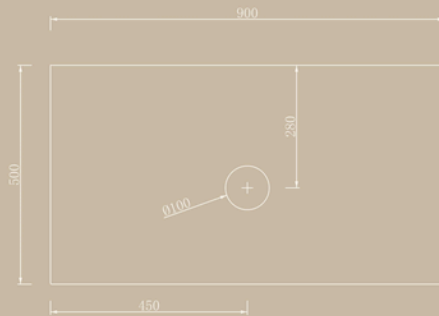
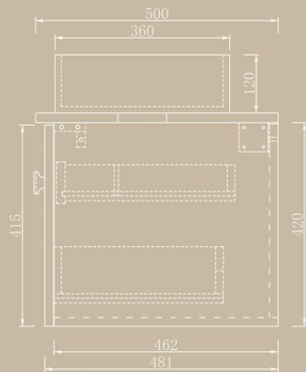

### STONE COLOUR:

+ Blanco Quartz

### CUSTOMISE STONE:

+ Customizable- price to be quote

### CUSTOMISE COLOUR(INTERIOR ONLY):

+ Customizable- any Dulux color, price to be quoted

### INQUIRIES:

hello@joinerybears.com

### CONSTRUCTION:

High density moisture resistant particle board, soft close drawer.

### INSTALLATION:

- + Wall hung, assembled vanity cabinet, no assembly needed.
  - + The vanity unit must be fixed to the wall by qualified tradesmen.
  - + Plumbing fixtures must be installed by a qualified plumber.
  - + Stone Top requires 1-2 people to lift the top to fit in cabinet.
  - + Silicon top and sides of vanity if necessary.
  - + No Tap hole unless requested.
- (Failure to do so will void the warranty)

### STRUCTURE:

- 1 x cutout drawer
- 1 x full-size drawer

### PACKAGE:

- + Vanity 32KG 980\*580\*480mm
- + Stone 24KG 1000\*500\*100mm
- + Basin 4KG 390\*390\*150mm

### MATERIAL:



+ Walnut veneer finish, MDF and Plywood, Solid Walnut

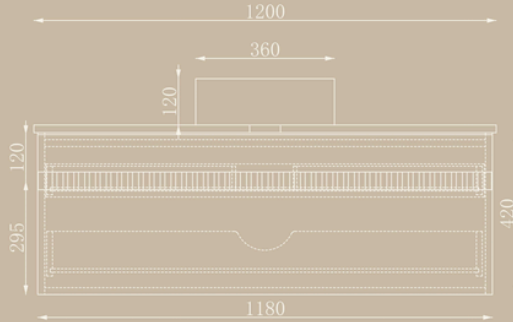
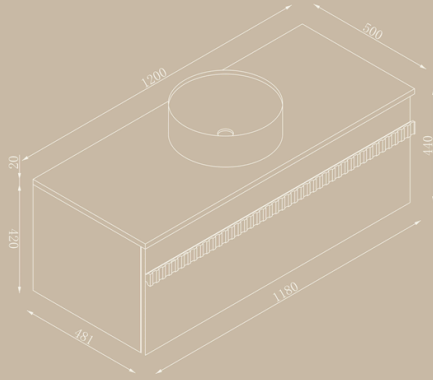

# Joinery by Bears.



### CABINET COLOUR:

- + Exterior 
- + Interior 

### BASIN:

- + White ceramic top mount
- + Allow 32 or 40mm waste (Sell separately)

### HANDLE:

- + Solid walnut

## The Ashton Vanity 1200

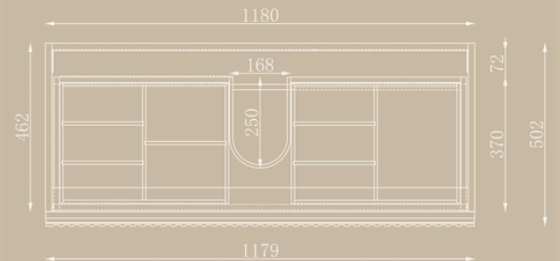
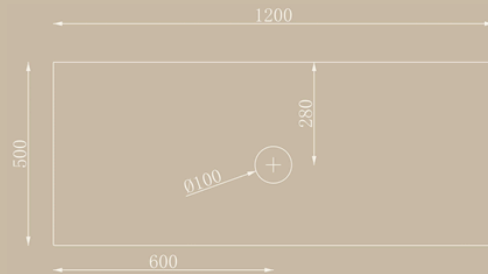
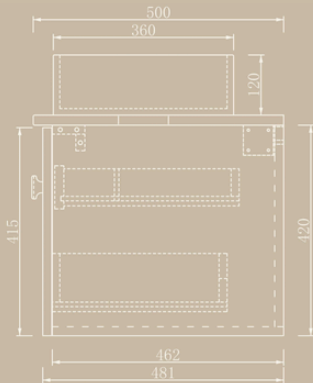

### STONE COLOUR:

- + Blanco Quartz

### CUSTOMISE STONE:

- + Customizable- price to be quote

### CUSTOMISE COLOUR(INTERIOR ONLY):

- + Customizable- any Dulux color, price to be quoted

### INQUIRIES:

hello@joinerybears.com

### CONSTRUCTION:

High density moisture resistant particle board, soft close drawer.

### INSTALLATION:

- + Wall hung, assembled vanity cabinet, no assembly needed.
  - + The vanity unit must be fixed to the wall by qualified tradesmen.
  - + Plumbing fixtures must be installed by a qualified plumber.
  - + Stone Top requires 1-2 people to lift the top to fit in cabinet.
  - + Silicon top and sides of vanity if necessary.
  - + No Tap hole unless requested.
- ( Failure to do so will void the warranty)

### STRUCTURE:

- 1 x cutout drawer
- 1 x full size drawer

### PACKAGE:

- + Vanity 39KG 1280\*580\*480mm
- + Stone 32KG 1300\*500\*100mm
- + Basin 4KG 390\*390\*150mm

### MATERIAL:

- + Walnut veneer finish, MDF and Plywood, Solid Walnut



# Joinery by Bears.

## CABINET COLOUR:

+ Exterior



+ Interior



## BASIN:

+ White ceramic top mount

+ Allow 32 or 40mm waste

(Sell separately)

## HANDLE:

+ Solid walnut

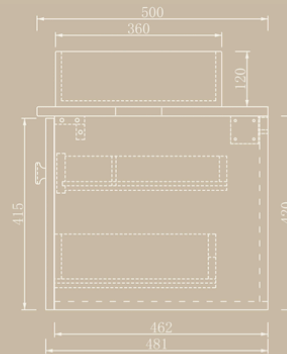
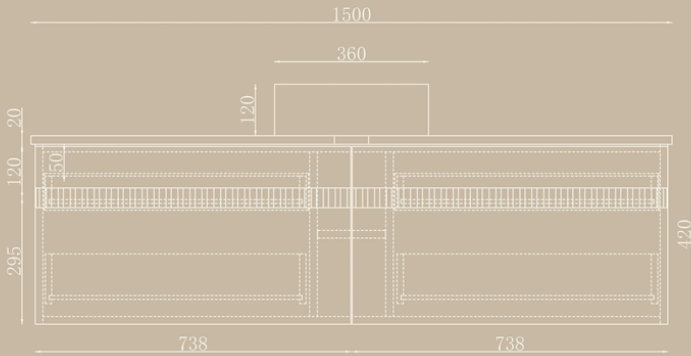

## The Ashton Vanity 1500 S

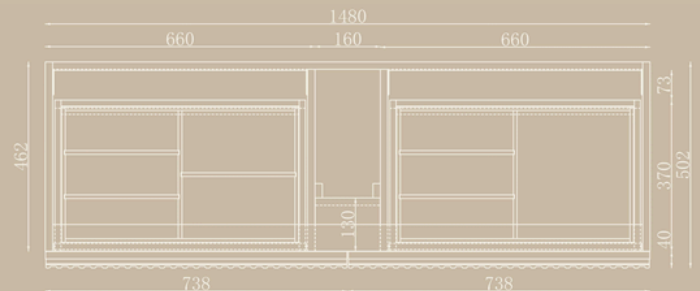
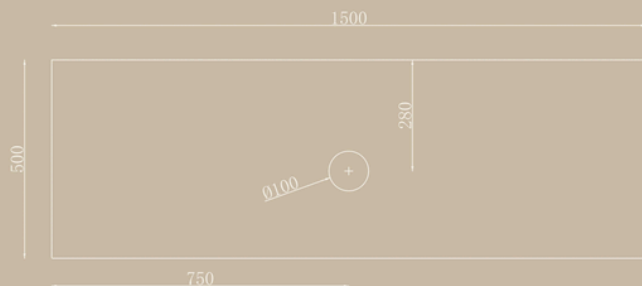

## STONE COLOUR:

+ Blanco Quartz

## CUSTOMISE STONE:

+ Customizable- price to be quote

## CUSTOMISE COLOUR(INTERIOR ONLY):

+ Customizable- any Dulux color, price to be quoted

## INQUIRIES:

hello@joinerybears.com

## CONSTRUCTION:

High density moisture resistant particle board, soft close drawer.

## INSTALLATION:

- + Wall hung, assembled vanity cabinet, no assembly needed.
  - + The vanity unit must be fixed to the wall by qualified tradesmen.
  - + Plumbing fixtures must be installed by a qualified plumber.
  - + Stone Top requires 1-2 people to lift the top to fit in cabinet.
  - + Silicon top and sides of vanity if necessary.
  - + No Tap hole unless requested.
- (Failure to do so will void the warranty)

## STRUCTURE:

- 1 x cutout drawer
- 1 x full size drawer

## PACKAGE:

- + Vanity 53KG 1580\*580\*480mm
- + Stone 39KG 1600\*500\*100mm
- + Basin 4KG 390\*390\*150mm

## MATERIAL:

+ Walnut veneer finish, MDF and Plywood, Solid Walnut



# Joinery by Bears.

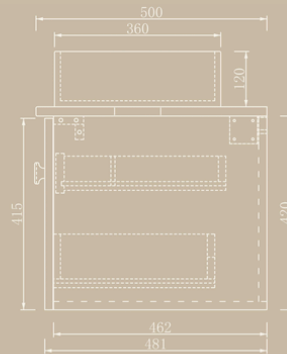
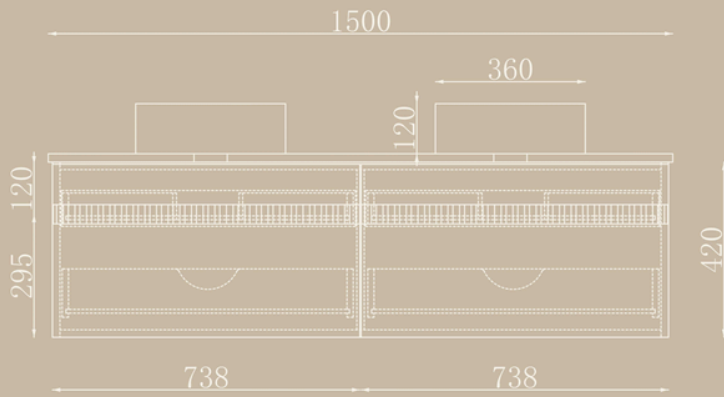

### CABINET COLOUR:

+ Exterior



+ Interior



### BASIN:

+ White ceramic top mount

+ Allow 32 or 40mm waste

(Sell separately)

### HANDLE:

+ Solid walnut

## The Ashton Vanity 1500 D

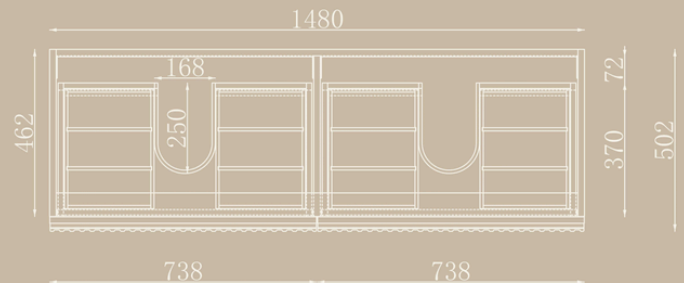
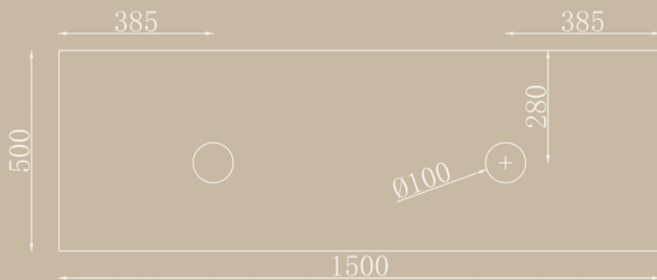

### STONE COLOUR:

+ Blanco Quartz

### CUSTOMISE STONE:

+ Customizable- price to be quote

### CUSTOMISE COLOUR(INTERIOR ONLY):

+ Customizable- any Dulux color, price to be quoted

### INQUIRIES:

hello@joinerybears.com

### CONSTRUCTION:

High density moisture resistant particle board, soft close drawer.

### INSTALLATION:

- + Wall hung, assembled vanity cabinet, no assembly needed.
  - + The vanity unit must be fixed to the wall by qualified tradesmen.
  - + Plumbing fixtures must be installed by a qualified plumber.
  - + Stone Top requires 1-2 people to lift the top to fit in cabinet.
  - + Silicon top and sides of vanity if necessary.
  - + No Tap hole unless requested.
- (Failure to do so will void the warranty)

### STRUCTURE:

- 1 x cutout drawer
- 1 x full size drawer

### PACKAGE:

- + Vanity 53KG 1580\*580\*480mm
- + Stone 39KG 1600\*500\*100mm
- + 2Basin 4KG 390\*390\*150mm X2

### MATERIAL:

+ Walnut veneer finish, MDF and Plywood, Solid Walnut



Congratulations on your new vanity cabinet! To ensure its beauty and functionality last for years, please follow these care and cleaning instructions:

## Regular Cleaning:

### 1. Dusting:

- Use a soft, dry cloth to dust the surface regularly.
- Avoid using rough or abrasive cloths that may scratch the finish.

### 2. General Cleaning:

- Wipe down the surface with a damp, soft cloth.
- Use a mild soap or detergent if needed. Dilute the soap in water and apply it with a cloth.
- Immediately dry the surface with a clean, soft towel to prevent water spots and moisture damage.

## Deep Cleaning:

### 1. Stubborn Stains:

- For tougher stains, use a mixture of water and a small amount of mild dish soap.
- Apply the solution to the stain with a soft cloth, gently rubbing in a circular motion.
- Rinse the area with a damp cloth and dry thoroughly.

### 2. Hardware Cleaning:

- Use a damp cloth to wipe down handles and other hardware.
- For brass handles, you may use a brass cleaner, but ensure it doesn't come into contact with the cabinet surface.

## Specific Material Care:

### 1. Painted Surfaces:

- Avoid harsh chemicals or abrasive cleaners that can damage the paint.
- Use a mild, non-abrasive cleaner diluted with water.

### 2. Marble Countertop (if applicable):

- Clean spills immediately to avoid staining.
- Use a pH-neutral cleaner specifically designed for marble.
- Avoid acidic or abrasive cleaners that can etch the surface.

## Preventative Care:

### 1. Avoid Excessive Moisture:

- Do not allow water or other liquids to sit on the surface for extended periods.
- Always wipe up spills immediately to prevent damage.

### 2. Heat Protection:

- Avoid placing hot items directly on the vanity surface. Use trivets or heat pads to protect the finish.

### 3. Use Gentle Cleaners:

- Avoid using bleach, ammonia, or other harsh chemicals.
- Opt for mild, non-abrasive cleaners designed for the specific materials of your vanity.

## Maintenance Tips:

### 1. Regular Inspections:

- Periodically check for any signs of damage or wear and address them promptly.
- Tighten any loose hardware to maintain the integrity of the cabinet.

### 2. Protective Coating:

- Consider applying a protective wax or sealant to the surface to enhance durability and shine.
- Follow the manufacturer's instructions for any products used.

By following these care instructions, you can ensure that your vanity cabinet remains beautiful and functional for many years. Thank you for choosing our product!

For any further questions or assistance, please contact our customer service team at:

- Email: [hello@joinerybears.com](mailto:hello@joinerybears.com)
- Phone: 0411 013 310

